

User Guide for Bluetooth Sleep Mask Model: VS001

COMFORT SLEEP MASK
WITH BUILT-IN BLUETOOTH® SPEAKERS



RETRACTABLE
MICRO USB
CHARGING CABLE



READ AND FOLLOW THIS OWNERS MANUAL CAREFULLY FOR PROPER USE AND MAINTENANCE OF THIS PRODUCT. PLEASE KEEP THIS MANUAL FOR FUTURE REFERENCE.

IMPORTANT

- Do not use Sleep Mask if it has been damaged in any way.
- Do not use this product for anything other than its intended use.
- Keep out of reach of children. This product is not a toy.
- Do not place Sleep Mask on or near hot surface.

CHARGING BLUETOOTH SLEEP MASK:

To charge Bluetooth Sleep Mask, connect the supplied charging cable to the Micro USB charging port and connect the other end to a USB power outlet (5V adapter not included). While charging, the LED will turn red. When the battery is fully charged, the RED LED light will turn OFF.

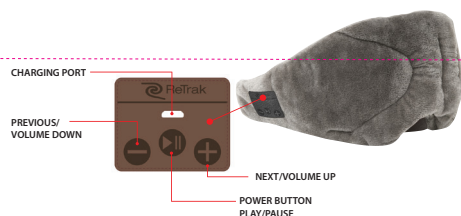

OPERATING BLUETOOTH SPEAKER:

- To turn power ON, hold down Power Button ►|| for 3 seconds until you hear a sound. To turn power OFF, repeat this step.
- The Sleep Mask is ready to pair and is discoverable when the blue light blinks rapidly. Scan from your Bluetooth enabled device for "Retrak Sleep Mask" and pair it. Once the pairing has been completed, LED lights will stop blinking. Your Sleep Mask is now ready for use with your device.
- To adjust the volume control, long press ◀ (volume down) or ▶ (volume up) on the speaker control panel.
- To change tracks, short press ◀ (for previous tracks) or ▶ (for next track) on the speaker control panel.
- To pause a track, press ►|| on speaker control panel.
- To prolong battery life, turn power OFF when Sleep Mask is not in use.

CARE & MAINTENANCE:

Do not machine wash. Spot clean only.

QUESTIONS or COMMENTS

For questions or comments regarding this or other ReTrak products, please call our toll-free number: 1-877-499-6072. Visit our website at www.myretrak.com or email us at support@myretrak.com. If problems persist, please do not attempt to repair unit; see warranty for factory service.

WARRANTY

Emerge Technologies, Inc. Limited Warranty Statement. Complete information regarding Emerge's warranties is listed below.

EMERGE TECHNOLOGIES, INC. ("Emerge") warrants to the original end user customer of its products specified below that its products are free from Material Defects as defined herein. Subject to the conditions and limitations set forth below, Emerge will, at its option, either repair or replace any part of its products that prove materially defective by reason of improper workmanship or materials. Material Defects are herein defined as non-cosmetic defects in a product's materials and workmanship which cause a malfunction in the product during proper use. Repaired parts or replacement products will be provided by Emerge on an exchange basis, and will be either new or refurbished to be functionally equivalent to new. If Emerge is unable to repair or replace the product, Emerge will, at its option, refund or credit the current value of the product at the time the warranty claim is made or substitute an equivalent product. Exceptions to Warranty Notwithstanding any other provision contained herein, this limited warranty does not cover any damage to a product that results from improper installation, accident, abuse, misuse, natural disaster, insufficient or excessive electrical supply, abnormal mechanical or environmental conditions, or any unauthorized disassembly, repair, or modification. This limited warranty also does not apply to any product on which the original identification information has been altered, obliterated or removed, has not been handled or packaged correctly, has been sold as secondhand or has been resold contrary to the US export regulations. This limited warranty covers only repair, replacement, refund or credit for materially defective products that are manufactured by Emerge, as provided above. Emerge is not liable for, and does not cover under warranty, any loss of data or any costs associated with determining the source of system problems or removing, servicing or installing Emerge products. This warranty excludes third party software, connected equipment or stored data. In the event of a claim, Emerge's sole obligation shall be replacement of the hardware; under no circumstances will Emerge be liable in any way for damages, including any lost profits, lost savings or other incidental or consequential damages arising out of the use of, or inability to use, such product.

Duration of Warranty:

Limited 1 Year Warranty.

Product Repair or Replacement:

If your product meets the criteria for warranty replacement, please contact Emerge Technologies at:

877-499-6072
support@myretrak.com
955 Freeport Pkwy, Suite 100, Coppell, Texas 75019
(Please be prepared to provide proof of purchase.)

This limited warranty applies only to the original end user customer of the product for so long as the original end user customer owns the product. This limited warranty is nontransferable.

THIS LIMITED WARRANTY IS GIVEN IN LIEU OF ALL OTHERS INCLUDING THE IMPLIED WARRANTY OF MERCHANTABILITY AND FITNESS FOR A PARTICULAR PURPOSE AND EXCLUDES ALL INCIDENTAL, CONSEQUENTIAL, PUNITIVE, EXEMPLARY OR SPECIAL DAMAGES.

Some states do not allow limitations on how long an implied warranty lasts or the exclusion or limitation of incidental or consequential damages, so these limitations may not apply to you. This warranty gives you specific legal rights that may vary from state to state.

Bluetooth® and  is a trademark or registered trademark of Bluetooth SIG. This product is not designed, manufactured or distributed by Bluetooth SIG.

Warning Statement

This equipment has been tested and found to comply with the limits for a Class B digital device, pursuant to part 15 of the FCC Rules. These limits are designed to provide reasonable protection against harmful interference in a residential installation. This equipment generates, uses and can radiate radio frequency energy and, if not installed and used in accordance with the instructions, may cause harmful interference to radio communications. However, there is no guarantee that interference will not occur in a particular installation. If this equipment does cause harmful interference to radio or television reception, which can be determined by turning the equipment off and on, the user is encouraged to try to correct the interference by one or more of the following measures:

- Reorient or relocate the receiving antenna.
- Increase the separation between the equipment and receiver.
- Connect the equipment into an outlet on a circuit different from that to which the receiver is connected.
- Consult the dealer or an experienced radio/TV technician for help.

Caution: Any changes or modifications to this device not explicitly approved by manufacturer could void your authority to operate this equipment.

This device complies with part 15 of the FCC Rules. Operation is subject to the following two conditions: (1) This device may not cause harmful interference, and (2) this device must accept any interference received, including interference that may cause undesired operation.

The device has been evaluated to meet general RF exposure requirement. The device can be used in portable exposure condition without restriction.